

CLEARLY UNSURPASSED

Fits all size door opening

Available in Standard Low-Temp (USDA), Ribbed and Reinforced PVC

Provides excellent climate control

Large selection of strip material to suit almost any application



Unsurpassed visibility for maximum safety in high traffic areas

Helps control and isolate noise between areas of plant activity

PVC Product comes in rolls, pre-cut strips and cut to size for door openings

SERIES 9010

CLEAR FLEXIBLE STRIP CURTAINS

Designed for any size door opening, the Super Seal "Clear Strip" is the most economical way to close a door opening. The clear flexible strips provide unsurpassed visibility for safety in high traffic areas. The edges of the strips are rounded to avoid the danger of being cut, concave-convex overlapping pattern enhances the sealing effect. The "Clear Strip" is the universal low cost enclosure that reduces heat and refrigeration costs, minimizes energy consumption, provides noise control, and increases employee comfort. The "Clear Strip" provides excellent visibility for oncoming traffic and thus increasing personnel safety. Clear Strip curtains help increase productivity by increasing personnel safety and thus help decrease energy and production costs.



SPECIFICATIONS

SERIES 9010 CLEAR STRIP CURTAINS

All doors shall be manufactured of non-toxic PVC with rounded edges, and concave-convex interlock. Strip material to be ___" x ___" thick, ___ standard, ___ low temperature, ___ welding strips, with ___ full, ___ partial overlap. Door shall be mounted using: #2 surface wall mounting with 2-1/2" x 1/8" thick galvanized steel flat bar or #1 under lintel with 2-1/2" x 1-1/2" x 1/8" thick galvanized steel angle bar / door shall be supplied with all necessary mounting hardware, galvanized to resist corrosion.

DOOR MODELS

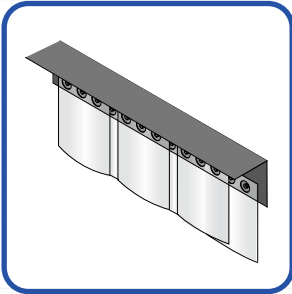

Model 9010-1
LINTEL MOUNT

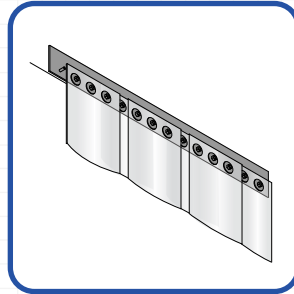

Model 9010-2
WALL MOUNT

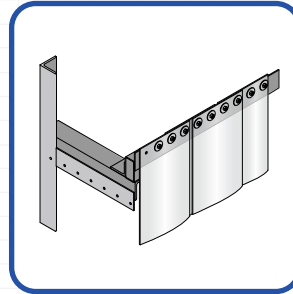

Model 9010-3
OFF WALL MOUNT

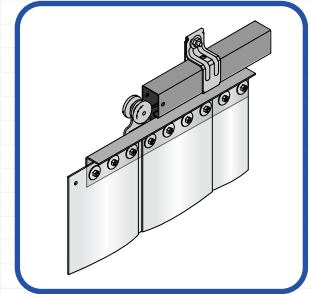

Model 9010-4
SLIDING BRACKET

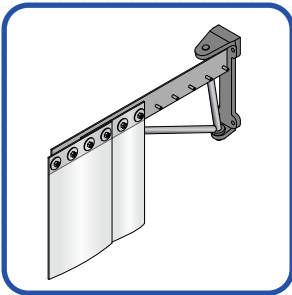

Model 9010-5
GRAVITY SWING

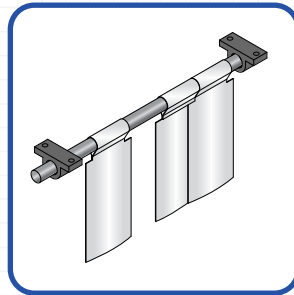

Model 9010-6
SUPER SWING

APPLICATION CHART

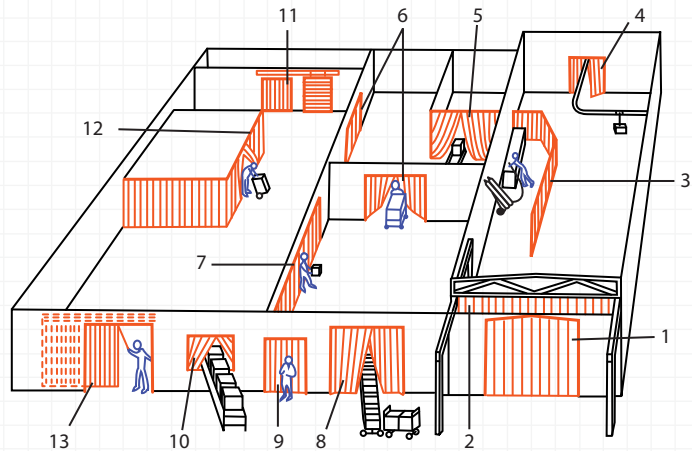

AVAILABLE TYPES OF PVC

STANDARD PVC

Standard (STD)
Ribbed
Anti-Static

LOW-TEMP (USDA)

Low-Temp (LT)
Ribbed
Reinforced

SHEET 48" WIDE - .080, .160, .250, .400

COLOURED

Orange
Black Opaque

WELDING

Amber
Green

- | | |
|--|---|
| 1. Large exterior doorways | 8. Loading dock receiving doors |
| 2. Crane-way enclosures | 9. Personnel doors |
| 3. Welding screens | 10. Conveyor openings |
| 4. Monorail Systems | 11. Secondary doors for coolers or freezers |
| 5. Storage areas enclosures | 12. Sound reducing enclosures |
| 6. Traffic doors | 13. Track mounted |
| 7. Environmental control between areas | |



DEALER IMPRINT



Custom Designs Available!

** All Super Seal products are subject to design modifications without notice. Product may be shown with non-standard options.